

DO NOT SCALE

Millimetres

0 10 100

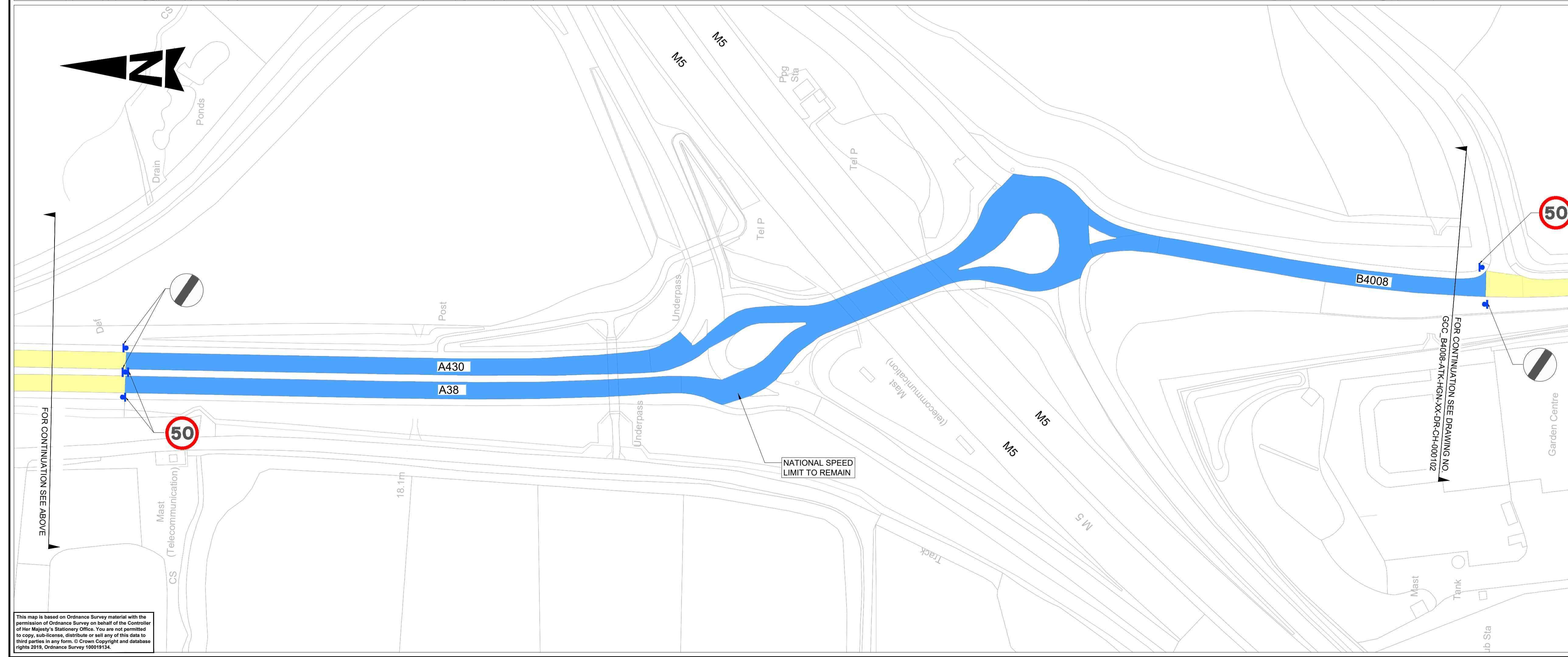
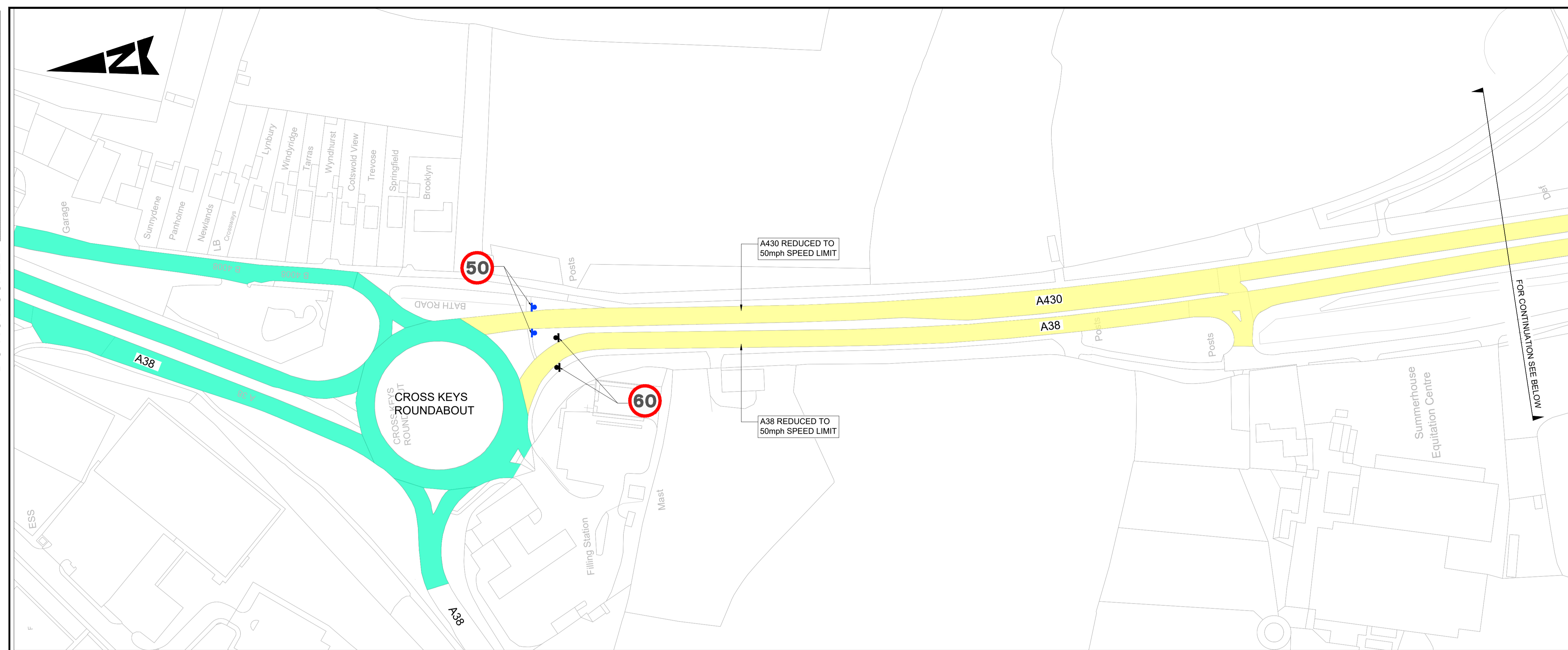

**NOTES:**  
 1. DO NOT SCALE FROM THIS DRAWING.  
 2. ALL DIMENSIONS ARE IN METRES UNLESS OTHERWISE STATED.

**KEY**

	NATIONAL SPEED LIMIT TO REMAIN.
	PROPOSED 50mph SPEED LIMIT.
	NOT BEING CHANGED AS PART OF THIS PROPOSAL.
	PROPOSED REGULATORY SIGN.
	EXISTING REGULATORY SIGN.

**SAFETY, HEALTH AND ENVIRONMENTAL INFORMATION**

In addition to the hazards/risks normally associated with the types of work detailed on this drawing, note the following significant residual risks (Reference shall also be made to the design hazard log).

Construction	NA
Maintenance / Cleaning	NA
Use	NA
Decommissioning / Demolition	NA

Status	Revision	Drawn	Checked	Reviewed	Authorised	Issue Date
Description: AMENDED AS PER TRO TEAM COMMENTS.						
S0	P04	MC	RS	APC	ATP	23/01/23
Description: AMENDED INCLUDING PHASE 1 ONLY						
S0	P03	MC	RS	APC	AJP	13/10/22
Description: AMENDED INCLUDING REVISED NORTHERN LIMITS						
S0	P02	MC	RS	APC	AJP	12/01/22
Description: FOR INFORMATION						
S0	P01	FK	RS	APC	AJP	08/06/21

FOR INFORMATION	S0
-----------------	----

**SNC-LAVALIN**  
**ATKINS**  
 Member of the SNC-Lavalin Group  
 Copyright © SNC Lavalin (2019) www.atkinsglobal.com

**Gloucestershire**  
 COUNTY COUNCIL

Project Title  
**A38/ A430/ B4008 BATH ROAD, GLOUCESTER.**

Drawing Title  
**A38, A430 & B4008 PROPOSED 50mph SPEED LIMIT EXTENSION - PHASE 1 TRO DRAWING. (PLAN 1 OF 2)**

Drawing Number	Project	Originator	Volume
GCC_B4008 - ATK - HGN - XX		- DR - CH - 000101	
Location	Project Ref. No.	Sheet	Rev.
A1	B4008	1 of 2	P04

This map is based on Ordnance Survey material with the permission of Ordnance Survey on behalf of the Controller of Her Majesty's Stationery Office. You are not permitted to copy, sub-license, distribute or sell any of this data to third parties in any form. © Crown Copyright and database rights 2019, Ordnance Survey 100019134.